



Wright Marshall
Estate Agents

26 MUSKETT DRIVE, WINNINGTON VILLAGE,
NORTHWICH CW8 4YP

OFFERS IN THE REGION OF £225,000



A well presented freehold property located in highly sought after Winnington Village

Externally

Driveway for multiple vehicles and gas metre located to the side aspect. A partly block paved partly lawn garden with a large shed, conveniently fitted with a hot water tap and electricity is located to the rear aspect.

Entrance Hallway

Entered via a frosted glass panelled uPVC door, laminate flooring, single radiator, stairs leading to landing and three ceiling spotlights.

Kitchen

11'8 x 7'3 (3.56m x 2.21m)

Vinyl tiles, single radiator, large double glazed window to the front aspect, low-level and eye-level units with oak effect tops, integrated fridge freezer, double Zanussi oven, gas hob and extractor fan, cupboard housing Ideal combi boiler, sink with drainer and six ceiling spotlights.

WC

Laminate flooring, single radiator, toilet, low-level sink, frosted double glazed window to the side aspect and one ceiling light point.

Lounge/Dining Room

14'1 x 15 (4.29m x 4.57m)

Karndean flooring, single radiator, TV aerial point, large double glazed windows to the rear aspect, French doors leading to rear garden, large built-in storage cupboard and one ceiling light point.

Landing

Loft hatch and one ceiling light point.

Bedroom One

13'2 x 7'3 (4.01m x 2.21m)

Single radiator, large double glazed window to the rear aspect and one ceiling light point.

Bedroom Two

11'4 x 7'6 (3.45m x 2.29m)

Single radiator, large double glazed window to the front aspect and one ceiling light point.

Bedroom Three

8'7 x 6'6 (2.62m x 1.98m)

Single radiator, double glazed window to the rear aspect and one ceiling light point.

Family Bathroom

Tiled flooring, floor to ceiling tiles, bath with power shower over, toilet, sink, heated towel rail, frosted double glazed window to the front aspect and four ceiling spotlights.

Ground Floor

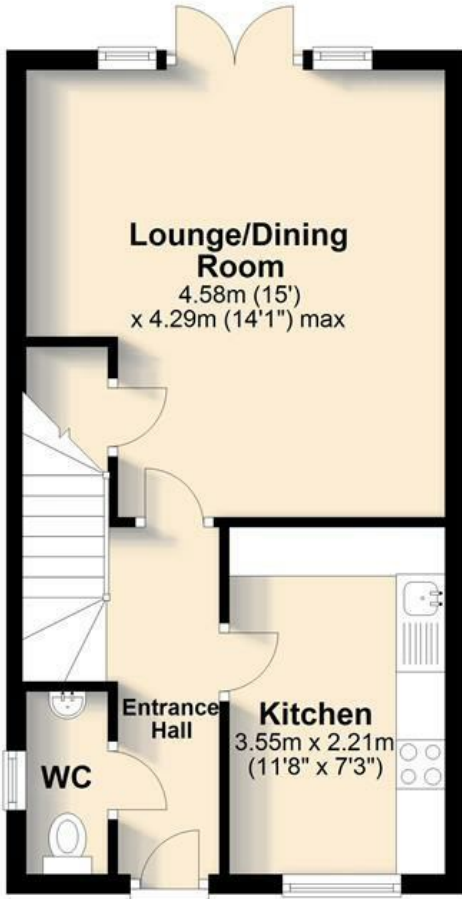

First Floor

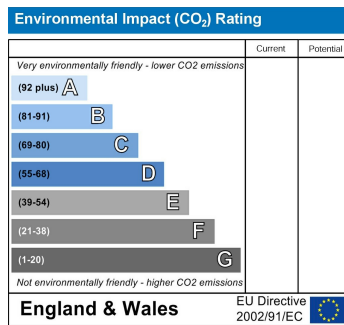
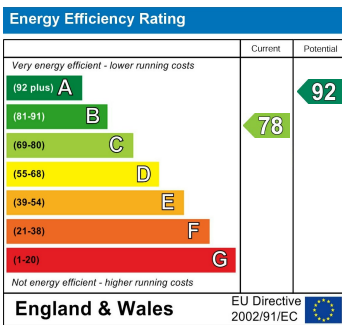
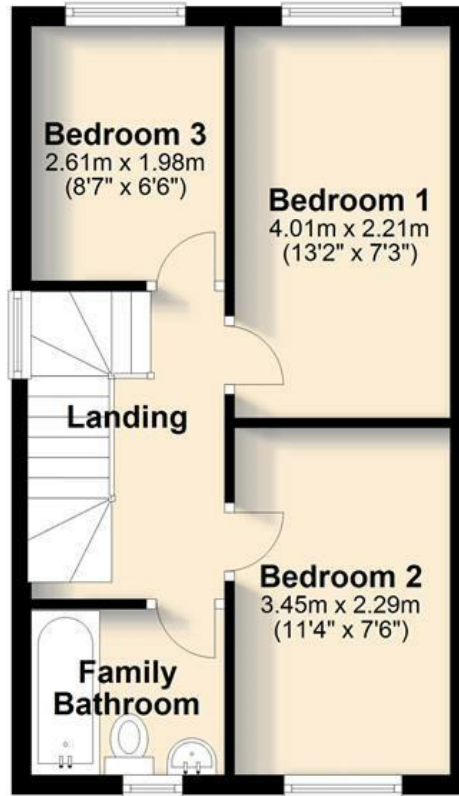

Wright Marshall
Estate Agents

